



Handheld Garment Steamer



Model No. ST-52

Read all instructions carefully before using this item.
Keep this manual for future reference.

CONGRATULATIONs

Congratulations on your new purchase! The Smartek® ST-52 is an amazing handheld garment steam appliance that gets rid of the most stubborn wrinkles easier, faster and with less hassle than traditional methods.

IMPORTANT SAFEGUARDS

When using electrical appliances, basic safety precautions should always be followed.

- Do not place the product too close to any heat emitting appliances or in direct sunlight.
- Check that the voltage indicated on the data plate corresponds with that of the local network before connecting the appliance to the main power supply.
- Do not submerge in water or any other liquids.
- It is imperative to unplug the appliance from the main power supply after use, before cleaning.
- Close supervision is required when using this product near children.
- NEVER leave the appliance within reach of children.
- Repairs to electrical appliances should only be performed by a qualified electrician. Improper repairs may place the user at serious risk.
- This appliance is intended for household use only and should not be used for industrial purposes.
- Do not operate this appliance with a damaged plug or cord, after a malfunction, or after being dropped or damaged in any way.
- Do not use this appliance for anything other than its intended uses.
- Steam produced by this unit is hot and pressurized. Care must be taken to avoid burns or other injuries.
- DO NOT shake the appliance while in use to avoid hot water splashing out.

IMPORTANT SAFEGUARDS

- Always ensure the unit has cooled thoroughly before re-filling with water, cleaning or storing.
- Always disconnect the appliance from the mains power supply when filling or emptying water. Ensure the water tank is emptied after each use before storing.
- DO NOT add chemicals or detergents to the water tank as they will damage the unit.
- The nozzle and accessories become hot during use. Do not touch the nozzle or attempt to change the accessories while the appliance is in use.
- Always hold the unit upright and do not fill to exceed the Max mark to avoid burns from splashing water.
- Use the unit with extreme caution with a tilted angle not more than 35°C in any direction to avoid excessive pilling from steam head.
- Always hold the unit away from the body and do not aim at people or animals.
- Do not operate the appliance if the steam opening is blocked.
- Always drain the remaining water from the appliance after each use to avoid mineral build-up in the heating plate.
- If the supply cord is damaged, it must be replaced by the manufacturer, service agent or a qualified person in order to avoid a hazard.
- This appliance is not intended for use by persons (including children) with reduced physical, sensory or mental capabilities, or lack of experience and knowledge, unless they have been given supervision or instruction concerning use of the appliance by a person responsible for their safety.

DESCRIPTION OF THE APPLIANCE

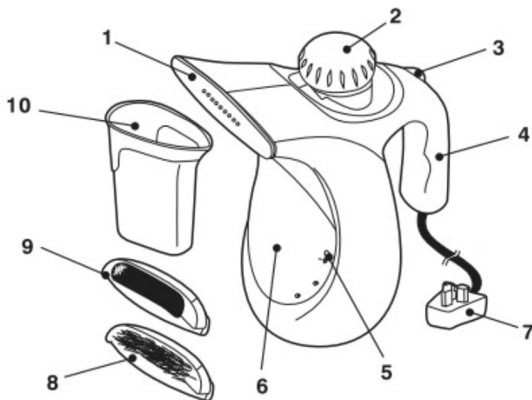

1. WIDE STEAM NOZZLE

2. WATER TANK CAP

3. ON/OFF SWITCH

4. ERGONOMIC HANDLE

5. MAX WATER LEVEL

6. WATER TANK

7. POWER CORD SET

8. FABRIC BRUSH

9. LINT REMOVER

10. MEASURING CUP

ACCESSORY ASSEMBLY

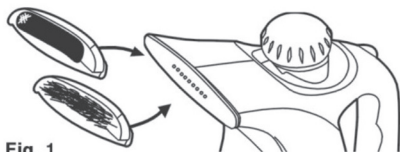

Fig. 1

ACCESSORY ASSEMBLY

- This appliance is supplied with two practical accessories:
Fabric Brush Smooths wrinkles and creases from fabrics
Lint Remover-Removes lint and loose threads from fabrics

Follow the steps below to attach the accessories to the steam nozzle:

- Ensure the unit is turned Off and no steam emits from the nozzle.
- Choose the required attachment and slide onto the steam nozzle as shown in Fig.1.
- Ensure the holes on the steam nozzle are aligned with the open slots on the accessories so that steam does not get blocked.
- **CAUTION:** To avoid burns do not attach accessories to the nozzle while steam is coming out of the nozzle.

Instructions

Filling the Water Tank

- Ensure the appliance is unplugged from the mains power supply.
- Place the Steamer on a flat, stable surface.
- Carefully unscrew and remove the water tank cap.
- Fill the water tank with water using the supplied measuring cup.
- Fill the tank with cold water to the desired time level ensuring not to exceed the MAX mark indicated in the water tank window.

Max-15-Steaming for 15 Minutes

10-Steaming for 10 Minutes

5- Steaming for 5 Minutes

- Replace the water tank cap ensuring it is thoroughly tightened.

CAUTION:

- After each use, always allow the unit to cool before filling with water and shooting steam from the fill hole.
- Extreme caution is required when pouring water into the water tank.
- Never fill water to exceed the Max fill line.

NOTE:

- Use of distilled or de-mineralized water is recommended to prolong the life of the steamer.
- Use water only; do not use detergents or other chemical substances.
- Mis use will lead to void warranty.

Instructions

Steaming Linens and Fabrics

Ensure the water tank has been filled and that the desired accessory is connected and then follow the steps below:

- Plug the unit into the main power supply and switch it on.
- Switch the unit on and the button will illuminate to indicate the appliance is on.
- Steam will emit from the nozzle after approximately 2 minutes.
- Direct the steam nozzle with either one of the accessories towards the materials you wish to steam.
- Keep the flow of steam focused on the material being steamed.

Using a slight back and forth motion over the area you are steaming further enhances the process.

CAUTION: Always be sure that the Steam Nozzle and any other attachments are pointed in safe direction away from the user, other people and animals when steam is emitting.

Steaming Garments

- Place the garment on a clean rust-free hanger.
- Direct the steam nozzle towards the bottom of the garment.
- Steam will rise on both the inside and the outside of the fabric removing wrinkles and creases. Slowly slide steam nozzle upwards from the bottom to the top of the garment.
- Direct the steam nozzle away from the garment and smooth the fabric with your free hand.
- Repeat as necessary until the garment is crease-free.

Instructions

Storage

- Unplug the power cord from the main power supply.
- Allow the unit to cool thoroughly (at least cool-to-touch).
- Remove all attachments from the unit.
- Drain the remaining water from the water tank to minimize potential mineral build-up. Loosely replace the water tank cap but do not tighten as it may be difficult to unscrew for future use.
- Store all accessories with the unit in a dry, cool location.

Removing Mineral Build-up

- Different water sources contain minerals and the sediment may cause mineral build-up in the steamer and affect the free flow of steam.

NOTE: The best way to avoid mineral build-up is to use distilled or de-mineralized water. If you are unable to do this, it is recommended to use the mineral build-up removal procedure.

- Unplug the unit and allow it to cool completely (at least cool-to-touch)
- Remove all accessories from the unit.
- Remove the water tank cap and drain any remaining water.
- Using a measuring cup, prepare a mixture of 0.125l. vinegar and 0.125l. water.
- Slowly pour the mixture into the water tank.
- Allow the unit to stand for 1-2 hours; drain solution when done.
- If the mineral build-up still remains in the unit, repeat the above steps until all build-up is removed.
- Rinse the water tank with fresh water, drain and repeat until the vinegar odour is eradicated.
- Replace the water tank cap.

Specifications & Troubleshooting

Unit Weight (Bare): 0.7kg

Capacity: 320ML

Steam Output Time: 2 minutes

Steam Duration: 14 minutes

Voltage: 120V~ 60Hz

Wattage: 700W

Problem	Possible Reasons	Solution
Unit fails to heat	Unit is not plugged in	Plug into mains power supply
	Switch is not activated	Press the On/Off switch The switch will illuminate
Unit heats up but fails to steam	Water tank is empty	Refill the water tank accordingly
	Mineral build-up in the unit	Follow the removing mineral build-up guide
	Thermo-fuse breakdown	Take to a certified service center
Steam output is intermittent	Mineral build-up in the unit	It is normal for the unit to stop steaming periodically for a few seconds. If the steam remains off for a longer period, follow the removing mineral build-up guide.

