



**Handheld Sewing Machine
Operating Instructions
Model Nos. SB011/SB022**



**Please read all instructions carefully before operating the
sewing machine.**

Keep this manual for future reference.

Parts Identification

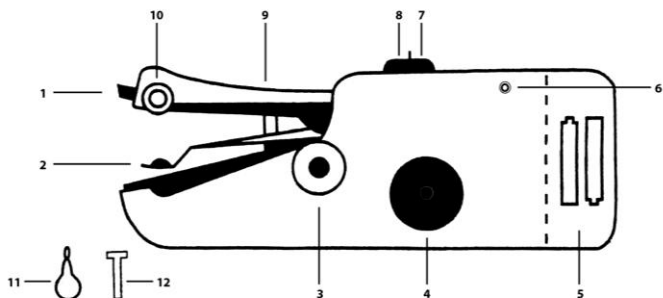

- | | |
|------------------------|-----------------------|
| 1. Set screw | 7. Lock/Unlock |
| 2. Fastening plate | 8. Power switch |
| 3. Bobbin | 9. Needle arm |
| 4. Rotary wheel | 10. Tension control |
| 5. Battery compartment | 11. Threader |
| 6. AC/DC Adapter slot | 12. Extension spindle |

For Your Safety:

- The needle is sharp, use care when working with the needle to avoid injury.
- Keep away from children.
- When not in use the machine should always be kept in a locked position.

Insert/Replace Batteries (not included):

Note: Make sure machine is in the locked position prior to battery replacement.

To open the compartment, press down on the arrow with your thumb and push in the direction of the arrow (**Figure 1**).

Insert four AA batteries in the battery compartment (**Figure 2**).

Once batteries are inserted, replace battery cover by sliding it back and clicking into place.

AC/DC adapter (not included)

Adapter must be 6V 800mA. Plugging in an adapter that has different ratings could damage the machine and adapter.

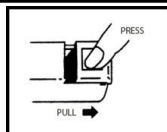

Figure 1

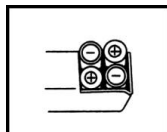

Figure 2

Directions for Use:

Ensure the machine is in the locked position (**Figure 3**).

Raise the needle arm to the highest position by turning the rotary wheel. (**Note:** The rotary wheel can be turned in either direction (**Figure 4**).

Lift up the fastening plate making sure not to push down on the needle arm (**Figure 5**). The arm can still be moved manually even when the machine is in the locked position.

Place the fabric to sew underneath the fastening plate. Thread two inches of thread through the needle.

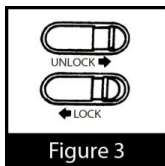

Figure 3

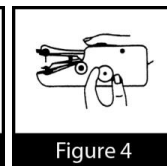

Figure 4

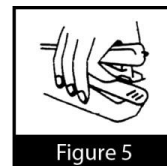

Figure 5

Hold the sewing machine with right hand and operate power switch with thumb, other fingers supporting the bottom.

Unlock the sewing machine. Press the power switch with your right thumb. The machine will automatically sew the fabric/cloth to the left (**Figure 6**).

Use the left hand to hold cloth and control the direction (do not rush the machine). When wider stitches are required, pull cloth to the left a little faster while you continue sewing.

Follow the centerline on cloth fastening plate to ensure straight stitching. To finish seam, raise the needle arm to the highest position by turning the rotary wheel. Use the back of a seam ripper or scissors to pull the thread out about three inches then cut it (**Figure 7**).

Turn the rotary wheel, lowering the needle into the cloth. Continue to turn the rotary wheel until needle arm is again at its highest position.

Lift up the fastening plate and take off the cloth to the left (**Figure 8**), making sure not pull the thread out the seam doing so can cause the seam to unravel.

Turn to backside of the cloth and guide the reserved 3 inches according to the following figures to make the knot (**Figure 9**):

1. First pass threader through the last stitch.
2. Put the reserved 3 inch thread through the threader hole.
3. Pull it out about 1 inch.
4. Guide the thread through the loop and pull it tight to finish the knot.

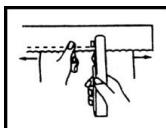

Figure 6

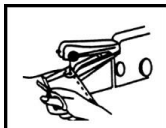

Figure 7

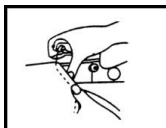

Figure 8

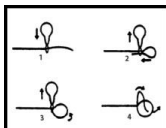

Figure 9

Threading the Machine:

Note: The spring must be in place before installing bobbin. Thread should flow from the top right of the bobbin or spool.

Pass thread through the eyelet on the needle arm (**Figure 10**).

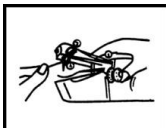

Figure 10

Handheld Sewing Machine

Pass thread over top of tension control, do not wrap completely around tension control (**Figure 11**).

Use the threader to pass the thread through the needle eye from back to the front.



Figure 11

To Use a Standard Thread Spool:

Loosen the bobbin nut and take off the bobbin. Slide thread spool onto extension spindle. Connect the extension spindle on bobbin shaft (**Figure 12**).

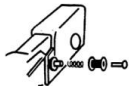

Figure 12

Replacing the Needle:

Loosen the set screw with a screwdriver and take off the old needle and insert a new one.

Needle must be installed with a flat side of the needle shank facing the front of handheld sewing machine.

Always use a # 14 style DHx1 sewing needle.

1 YEAR LIMITED WARRANTY

The Handheld Sewing Machine is warranted for 1 year from provable date of purchase against defects in material and workmanship. During this period such defects will be repaired, or the product will be replaced without charge. This warranty does not cover damage caused by misuse, negligence or improper installation. Warranty is also invalid in any case that the product is taken apart or serviced by an unauthorized service station. Send your package postage prepaid with a copy of your proof of purchase. You will also need to enclose a letter explaining the nature of your difficulty in detail. Please allow 2-4 weeks for return shipping.

Smartek USA Inc. • 49 Bartlett Street Brooklyn, NY 11206 • 1-877-678-6232

Sunbeam™ logo is a trademark of Sunbeam Products, Inc. used under license.